

4.15625

4 FIT DIMMER INSIDE THE WALL-BOX

- Carefully position all wires inside the wall-box, leaving enough room to insert the dimmer housing.
- Secure the dimmer inside the wall-box using the provided mounting screws.

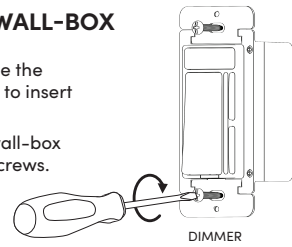

5 SEPARATE MOUNTING FRAME FROM WALL PLATE

Gently insert screwdriver into slots to separate mounting frame from wall plate.

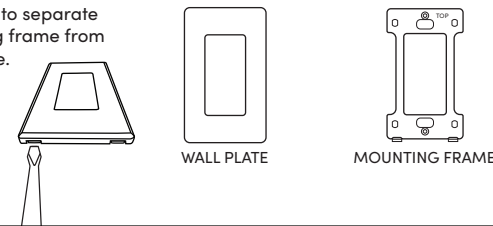

6 INSTALL MOUNTING FRAME

Place the mounting frame over your installed dimmer and secure it using provided screws.

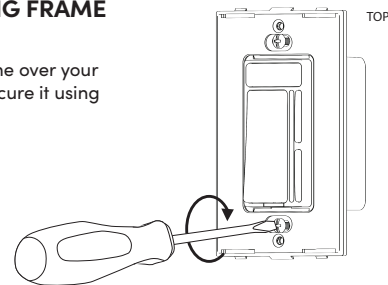

7 INSTALL WALL PLATE

Snap the decorative wall plate over the installed mounting frame with the top first then the bottom.

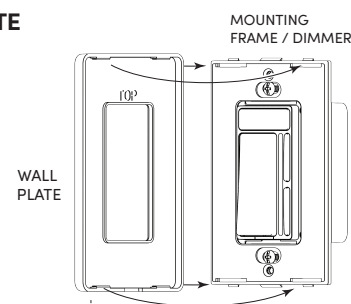

WALL PLATE SNAPS ONTO MOUNTING FRAME

8 DIMMER OPERATION

Restore power to enable dimmer operation. The indicator light bar on the dimmer will illuminate.

Continue to smart setup guide to enable smart features.

MULTI-GANG INSTALLATION

You may need to purchase multi-gang cover plates (not included). If there is a previous dimmer in the switch box, be sure to turn the power OFF at the circuit breaker or fuse box and then remove the wall-plate.

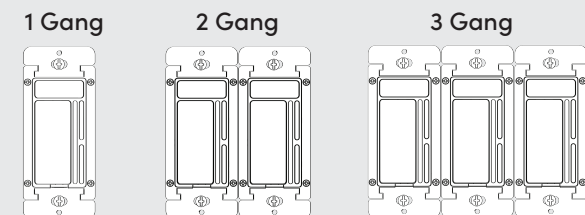

WHEN INSTALLING THIS DIMMER IN MULTI-GANG LOCATIONS, FOLLOW THE MAXIMUM RATINGS BELOW:

MAXIMUM RATINGS	1-GANG	2-GANG	3-GANG
DIMMABLE LED	300W	200W	150W
INCANDESCENT	500W	400W	300W

4.21875

Make it smart and get all the features

QUICK SMART SETUP GUIDE

- Download the LIFX App and sign up / in.
- Follow the install instructions in this booklet and power up your Dimmer.
- Press the + button in the bottom right and choose to add a device.

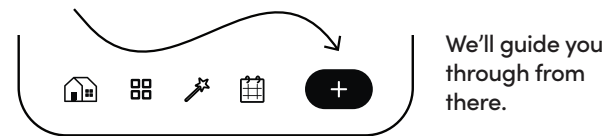

We'll guide you through from there.



← SCAN FOR VIDEOS AND SETUP GUIDES

When wired to LIFX lights:

To work with a LIFX lighting product you must connect your LIFX Dimmer to the LIFX app to enable smart control and follow the steps to select the connected lights.

NOTE: When connecting to any smart lights

The LIFX Dimmer must be configured to be used with Smart Lights within the LIFX App, when using a LIFX Light connected to the Load of the LIFX Dimmer.

4.3125

NEED HELP??

FAQs and the latest versions of user guides can be found at lifx.com/support.

WARNING:

This product may represent a possible shock or fire hazard if improperly installed or attached in any way. Product should be installed in accordance with the owners manual, current electrical codes and/or the current National Electric Code (NEC).

RISK OF ELECTRIC SHOCK: TURN OFF THE MAIN POWER AT THE CIRCUIT BREAKER BEFORE INSTALLING.

CAUTION: FOR CONTROL OF INCANDESCENT OR LED LUMINAIRES ONLY.

CAUTION: RISK OF FIRE:

- DO NOT USE WITH CONTROL RECEPTACLE OUTLETS, FLUORESCENT LIGHTING FIXTURES, MOTOR-OPERATED APPLIANCES OR TRANSFORMER SUPPLIED APPLIANCES.
- DO NOT EXCEED ELECTRICAL RATINGS
- USE ONLY COPPER WIRES WITH THIS DEVICE
- USE INDOORS ONLY
- SHALL INSTALL IN A METALLIC OUTLET BOX HAVING MIN. WIDTH 50MM, OR A NON-METALLIC BOX.

ONLY USE WITH SOLID COPPER WIRE OR COPPER-CLAD WIRE.

CAUTION: TO REDUCE THE RISK OF OVERHEATING AND POSSIBLE DAMAGE TO OTHER EQUIPMENT, DO NOT INSTALL TO CONTROL A RECEPTACLE, A MOTOR-OPERATED APPLIANCE, A FLUORESCENT LIGHTING FIXTURE OR A TRANSFORMER-SUPPLIED APPLIANCE.

FOR SUPPLY CONNECTION, USE WIRES RATED FOR AT LEAST 90°C

PARTS INCLUDED

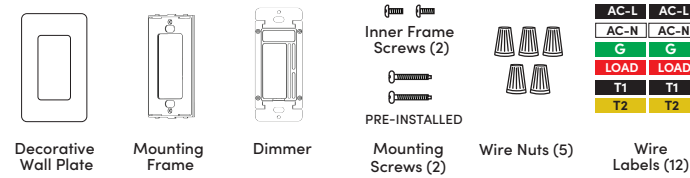

TROUBLESHOOTING TIPS

Difficulty connecting dimmer to a Wi-Fi network:

- Make sure the Wi-Fi network is a 2.4 GHz network.
- Smart Dimmer will not connect to a 5 GHz network.
- Test your Wi-Fi network with other devices such as your phone to make sure it is operating properly.
- The Wi-Fi connection may not have good coverage during set up. Try moving your Wi-Fi router closer, using a Wi-Fi extender or other Wi-Fi troubleshooting tips.
- Your Wi-Fi network password is case sensitive, make sure you are entering it correctly.

Lights are flickering:

- Lamp has a bad connection - check the connections or tighter any loose bulbs.
- The wire connections are not firmly secured - check the wiring is securely connected.

Light does not turn ON

- Circuit breaker or fuse has tripped.
- Bulb or lamp is burned out.

LED Bar indicator light does not turn ON:

- Neutral is not connected to dimmer (white wire).
- Confirm that dimmer is being supplied from a 120 V AC, 60 Hz source ONLY.
- Wiring is incorrect - check the wire configuration matches this manual and consult an electrician if unsure.

Intermittent dimmer operation:

- Confirm that the Load being controlled does not exceed 500W incandescent or 300W LED.

REPLACING LIGHT BULBS

- Make sure dimmer switches are in off position (no light level indicator lights are lit).
- To ensure there is no power at the socket when replacing light bulbs, turn off power at circuit breaker or fuse.
- Air gap switch can be used to disable the dimmer in single pole (only one smart dimmer on a circuit and no other switch or dimmer) applications. This is not intended to replace turning off power at circuit breaker or fuse.

NOTE: Dimmable LEDs may not dim as low as incandescent bulbs. Dimming range of dimmable LEDs can vary from manufacturer to manufacturer. This dimmer has an adjustable dimming range. If your bulbs do not dim to your satisfaction, hum, buzz or flicker check that they are compatible with a dimmer.

Compatible with most dimmable LED bulbs. Dimming performance may not be the same to dimming of incandescent bulbs. Some possible dimming variations include but are not limited to: less dimming range than an incandescent bulb; dimming less smooth than an incandescent bulb; flicker or shimmer at certain light levels; and, buzzing or humming at certain light levels.

4.3125



LIFX Dimmer

Safety Instructions + Install Guide



Installation Requires a Neutral Wire

Connects to your 2.4 GHz Wi-Fi network.

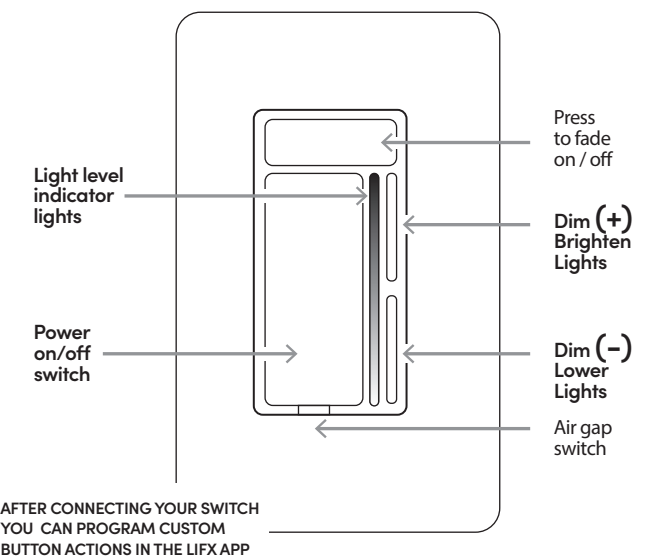

AFTER CONNECTING YOUR SWITCH YOU CAN PROGRAM CUSTOM BUTTON ACTIONS IN THE LIFX APP

These are your matter codes. Power your switches, then you can quickly add each using these codes.

MATTER SETUP

IMPORTANT! Keep these codes.



Each Dimmer has a Matter code printed on the back of the Dimmer, as well as attached on a sticker above.



← SCAN FOR VIDEOS AND SETUP GUIDES

120 Volt • 60Hz
500 Watt MAX incandescent
300 Watt MAX dimmable LED

Get started →

IMPORTANT, RETAIN FOR FUTURE REFERENCE: READ CAREFULLY

Installing the LIFX Smart Dimmer

NOTE: INSTALLATION OF THIS SMART DIMMER REQUIRES A NEUTRAL WIRE. IF A NEUTRAL WIRE IS NOT CONNECTED, THIS DIMMER WILL NOT WORK. CONSULT A QUALIFIED ELECTRICIAN.

1 WARNING: TO AVOID FIRE, SHOCK OR DEATH, TURN OFF POWER AT CIRCUIT BREAKER OR FUSE AND TEST THAT POWER IS OFF BEFORE WIRING.

2 IDENTIFY YOUR WIRING: SINGLE POLE OR 3-WAY

Note: if you are not certain you have the wiring described here, consult a qualified electrician for assistance.

2a. Open the outlet box and look for the neutral wire. If you do not have a neutral wire these dimmers will not work.

2b. Determine if you have Single Pole or 3-Way wiring and label your wires. Review Diagram A and B below to find the closest match.

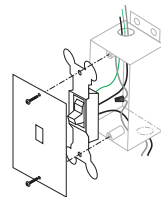

SINGLE POLE

3-WAY

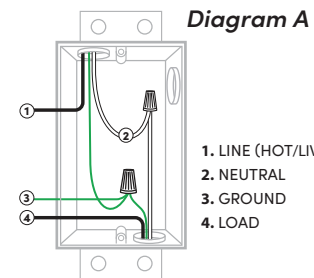

Diagram A

1. LINE (HOT/LIVE)
2. NEUTRAL
3. GROUND
4. LOAD

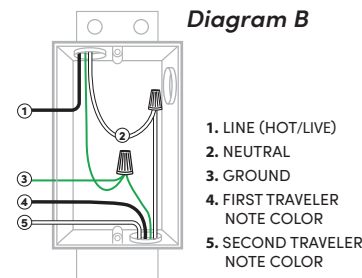

Diagram B

1. LINE (HOT/LIVE)
2. NEUTRAL
3. GROUND
4. FIRST TRAVELER
NOTE COLOR
5. SECOND TRAVELER
NOTE COLOR

LABEL YOUR WIRES:

1. Label the incoming 120V LINE (HOT) wire (usually black) with the black label AC-L
2. Label the green wire or bare wire GROUND with the green label G
3. Label the other wire (usually white) NEUTRAL with the white label AC-N
4. Label the other wire LOAD with the red label LOAD

LABEL YOUR WIRES:

First, determine which location is the "LINE side" and the "LOAD side".
NOTE: The old switch may have a screw terminal of a different color (usually black). The wire connected to this terminal will be connected either to the 120V "Line" or to the fixture "Load".

Second, determine the two TRAVELER wires that travel between the switch locations.

In the location connected to the incoming 120V "LINE".

1. Label the incoming 120V LINE wire (usually black) with the black label AC-L.
2. Label the black TRAVELER wire T1 and the second TRAVELER wire T2.
3. Label the green or bare copper ground wire with the green label G.
4. Label the white NEUTRAL wire with the white label AC-N

In the location connected to the Fixture "LOAD".

1. Label the wire running to the fixture LOAD (usually black) with the red label LOAD.
2. Label the black TRAVELER wire T1 and the second TRAVELER wire T2.
3. Label the green or bare copper ground wire with the green label G.
4. Label the white NEUTRAL wire with the white label AC-N

DISCONNECT WIRES AND REMOVE THE OLD SWITCH

PREPARING YOUR WIRES

Use with #12 or #14 AWG solid copper wire or copper-clad wire. Strip wires to 0.80 inch. Do not use stranded wire.

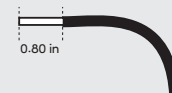

! NOTE: FOR ALL THE STEPS BELOW IF YOU ARE NOT CERTAIN YOU HAVE THE WIRING DESCRIBED CONSULT A QUALIFIED ELECTRICIAN FOR ASSISTANCE.

3 WIRE YOUR DIMMER

A SINGLE POLE One Smart Dimmer on a Circuit

MAKE THE WIRE CONNECTIONS

1. Take the existing live wire and the LIFX Dimmer live wire (BLACK) and connect them together using one of the wire nuts provided in this kit.
2. Take the existing load wire and the LIFX Dimmer load wire (RED) and connect them together with a wire nut.
3. Take the existing neutral wire and the LIFX Dimmer neutral wire (WHITE) and connect them together with a wire nut.
4. Take the existing ground wire and the LIFX Dimmer ground wire (GREEN) and connect them together with a wire nut.

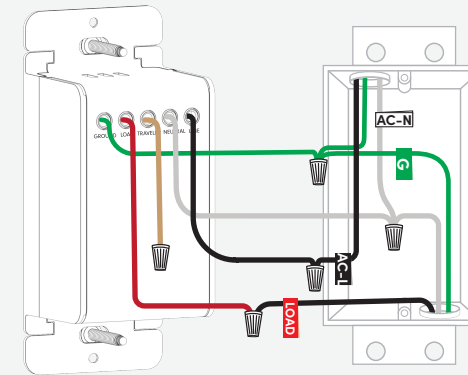

T2: UNUSED CONNECTION - KEEP SAFE BY NOT LEAVING EXPOSED

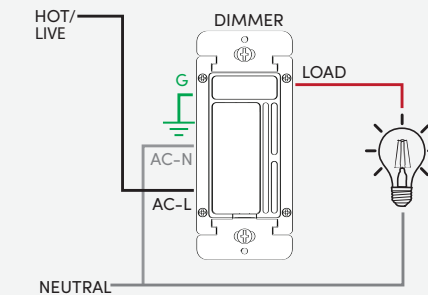

B 3-WAY One Smart Dimmer with a Switch on the Same Circuit

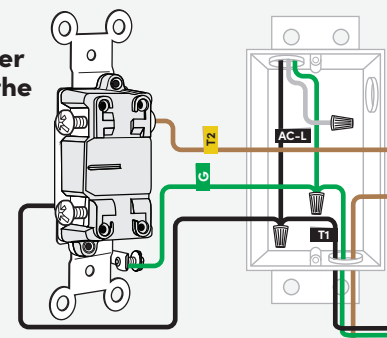

NOTE: The smart dimmer must be connected to the load (fixture)

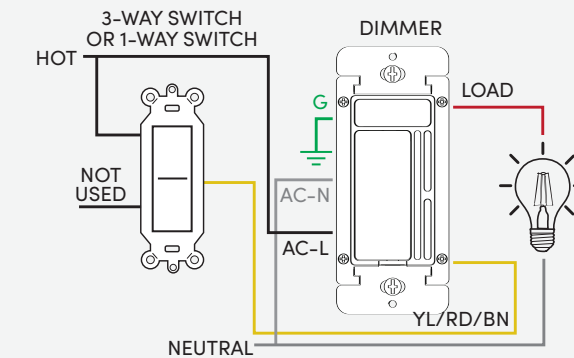
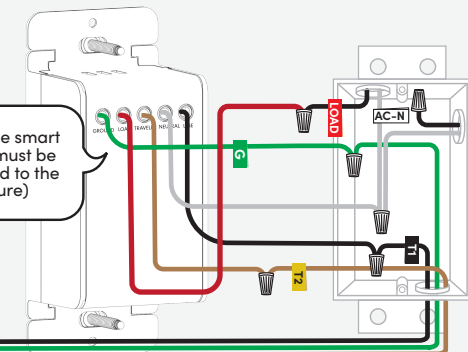

For your existing or regular switch in the location connected to the Incoming 120V Line: **THE REGULAR SWITCH MUST BE INSTALLED IN THIS LOCATION.**

1. Locate the wire marked AC-L and the wire labeled T1 TRAVELER (possibly black). Connect these to the 3-way switch as shown.
2. Locate the wire marked T2. Connect it to the 3-way switch as shown.
3. Connect the GROUND wires as shown. The ground wire may be bare copper or may be green color. Attach one GROUND wire to the switch and ensure any other GROUND wires are also connected.

Locate where the load (fixture) is connected currently. This is where the LIFX Dimmer must be installed.

1. Take the existing load wire and the LIFX Dimmer load wire (RED) and connect them together with a wire nut.
2. Take the existing wire labeled T1 (possibly colored black) and the LIFX Dimmer live wire (BLACK) and connect them together with a wire nut.
3. Take the existing wire labeled T2 and the LIFX Dimmer traveler wire (BROWN) and connect them together with a wire nut.
4. Take the existing neutral wire and the LIFX Dimmer neutral wire (WHITE) and connect them together with a wire nut.
5. Take the existing ground wire and the LIFX Dimmer ground wire (GREEN) and connect them together with a wire nut.

NOTE: A normal 1-Way Switch can be used in this application.

! IF YOU'RE NOT SURE, CONSULT A QUALIFIED ELECTRICIAN

C 3-WAY Two Smart Dimmers on the Same Circuit

NOTE: The unused load wire must be safely insulated, not left exposed.

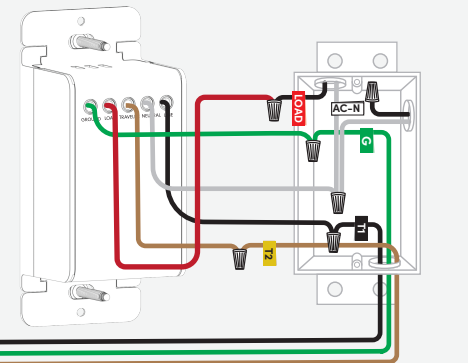
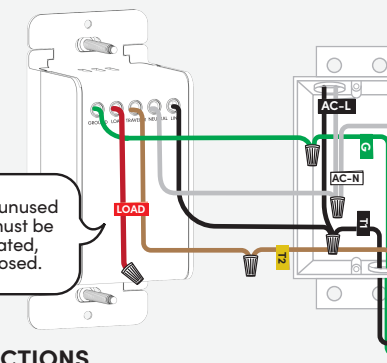

MAKE THE WIRE CONNECTIONS

- FOR SMART DIMMER IN THE LOCATION CONNECTED TO THE INCOMING 120V LINE:**
1. Take the existing wire labeled live (BLACK), the LIFX Dimmer live wire (BLACK) and the T1 Traveler wire (possibly BLACK) and connect them together with a wire nut.
 2. Take the existing wire labeled T2 and the LIFX Dimmer traveler wire (BROWN) and connect them together with a wire nut.
 3. Take the existing neutral wire and the dimmer neutral wire (WHITE) and connect them together with a wire nut.
 4. Take the existing ground wire and the dimmer ground wire (GREEN) and connect them together with a wire nut. Ensure any other GROUND wires are also connected.

- FOR SMART DIMMER IN THE LOCATION CONNECTED TO THE LOAD (FIXTURE):**
1. Take the existing load wire and the dimmer load wire (RED) and connect them together with a wire nut.
 2. Take the existing T1 Traveler wire (possibly BLACK) and the LIFX Dimmer live wire (BLACK) and connect them together with a wire nut.
 3. Take the existing wire labeled T2 and the LIFX Dimmer traveler wire (BROWN) and connect them together with a wire nut.
 4. Take the existing neutral wire and the dimmer neutral wire (WHITE) and connect them together with a wire nut.
 5. Take the existing ground wire and the dimmer ground wire (GREEN) and connect them together with a wire nut. Ensure any other GROUND wires are also connected.

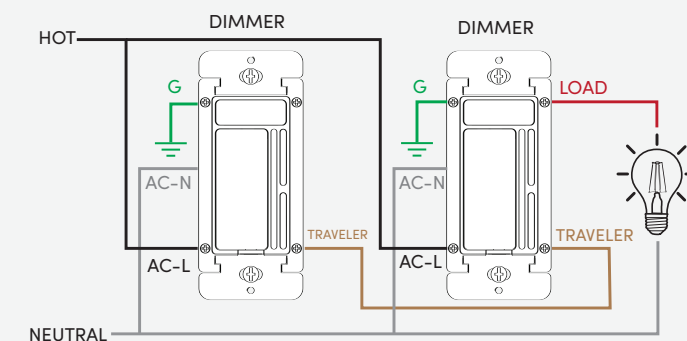

Both LIFX Dimmers should be connected to a Live, Neutral and Ground Wire

Need Help?

We've got tips & articles at support.lifx.com or you can chat with us on LIFX.com

Regulations & Compliance.

FCC Compliance Statement U.S.

This equipment has been tested and found to comply with the limits for a Class B digital device, under Part 15 of the FCC Rules. These limits provide reasonable protection against harmful interference in a residential installation. This equipment generates, uses and can radiate radio frequency energy and, if not installed and used under the instructions, may interfere with radio or television reception, which can be determined by turning the equipment off and on. The user is encouraged to correct the interference by one or more of the following measures:

Reorient or relocate the receiving antenna

- Increase the separation between the equipment and the receiver
- Connect the equipment into an outlet on a circuit different from that to which the receiver is connected
- Consult the dealer or an experienced radio/TV technician for help

Changes or modifications not approved by LIFX can void the user's authority to operate the equipment. This device complies with Part 15 of the FCC Rules. Operation is subject to the following two conditions: (1) This device may not cause harmful interference, and (2) this device must accept any interference received, including interference that may cause undesired operation.

Contains FCC ID: 2BBKALCM4DIM

Note: The Grantee is not responsible for any changes or modifications not expressly approved by the party responsible for compliance. Such modifications could void the user's authority to operate the equipment.

The device has been evaluated to meet general RF exposure requirement.

To maintain compliance with FCC's RF exposure guidelines, the distance must be at least 20 cm between the radiator and your body, and fully supported by the operating and installation.

Changes & modification

Changes or modifications made to this device may void certification of the device. Changes or modifications made to this unit not expressly approved by the party responsible for compliance could void the user's authority to operate the equipment.

Frequency Information

Frequency Range (US & Canada): 2412-2462 MHz;

Maximum radio-frequency power transmitted: 22.50dBm

Modulation type : IEEE 802.11 b/g/n/ax

Installation requirements & recommendation

This device should only be installed in light fittings and fixtures that are designed to accept each fitting. Lamps, fittings and fixtures that are designed to accept smaller or lower wattage light bulbs may result in the LIFX bulb operating below its optimal capacity. This device should only be used with compatible dimmable lighting loads.

Ensure the connected lighting load does not exceed the rated electrical limits.

Maintain a minimum distance of 20 cm between the device antenna and the user to comply with RF exposure requirements.

Interference

LIFX has been designed to minimize interference with other radio, broadcast or receiving devices. The manufacturer is not responsible for any interference caused as a result of modifications to the product or by failure to adhere to the recommendations in this document and at support.lifx.com. This device generates radio frequency energy and, if not installed in accordance with the "recommended installation requirements" may cause harmful interference to radio communication devices. If the device is causing radio interference it is recommended that the user try:

- relocating the device to a different place;
- adjust the antenna on the receiving device;
- consult a technician experienced in radio interference.

Notices

LIFX is not designed for use in:

- Excessively hot environments (e.g. close to ovens, radiators, heaters, etc.)
- Regions or countries other than that in which the product was intended for
- Outdoor and wet areas, except where the LIFX Product specifies that it is for both Indoor and Outdoor use

When using LIFX

- Switch off the power supply before opening the fixture
- Do not open device, as this will void the warranty
- Do not clean the device when it is powered on. If cleaning the product, use a soft dry cloth, do not use cleaning agents

Limited Warranty

General

Feit Electric Co ("LIFX") warrants the LIFX Dimmer (the "Product"), and only the Product, against defects in materials and workmanship under normal use ("Defect") for a period of TWO YEARS from the date of retail purchase by the original purchaser ("Warranty Period"). Under this Limited Warranty, if a defect arises and a valid claim is received by LIFX within the Warranty Period, at its option and to the extent permitted by law, LIFX will either: 1. repair the Product at no charge, using new or refurbished replacement parts --or-- 2. exchange the Product with a new or refurbished Product.

In the event of a defect, to the extent permitted by law, these are your sole and exclusive remedies. A replacement Product or part assumes the remaining warranty of the original Product or ninety (90) days from the date of replacement or repair, whichever is longer. When a Product or part of the Product is exchanged, any replacement item becomes your property and the replaced item becomes LIFX's property. Parts provided by LIFX in fulfillment of its warranty obligation must be used in Products for which warranty service is claimed.

Exclusions & Limitations

This Limited Warranty applies only to the Product manufactured by or for LIFX that can be identified by the "LIFX trademark, trade name, or logo affixed to it. The Limited Warranty does not apply to any (a) LIFX products and services other than the Product, (b) non-LIFX hardware product, (c) consumables (such as batteries), or (d) software, even if packaged or sold with the Product or embedded in the Product. Refer to the licenses accompanying the software for details of your rights with respect to its use. LIFX does not warrant that the operation of the Product will meet your needs or requirements or be uninterrupted or error free. LIFX is not responsible for damage arising from failure to follow instructions relating to the Product's use or from failures resulting from inadequate electrical supply or internet access. This warranty does not apply to a Product or part of the Product that has been altered or modified (e.g. to alter functionality or capability) by anyone who is not a representative of LIFX or if the Product is inserted or installed in a casing not provided by LIFX. In addition, this Limited Warranty does not apply to Defects or damage caused by (a) use with non-LIFX products; (b) accident, abuse, misuse, flood, fire, earthquake or other external causes or abnormal conditions; (c) operating the product outside the permitted or intended uses or conditions described by LIFX or with improper voltage or power supply; or (d) service (including upgrades and expansions) performed by anyone who is not a representative of LIFX. Recovery and reinstallation of software programs and user data are not covered under this Limited Warranty. This Limited Warranty does not cover the cost of returning the Product to LIFX; this is your responsibility. No LIFX reseller, agent, or employee is authorized to make any modification, extension, or addition to this Limited Warranty. If any term is held to be illegal or unenforceable, the legality or enforceability of the remaining terms shall not be affected or impaired.

EXCLUSIVE WARRANTIES

THE WARRANTIES SET FORTH HEREIN ARE THE EXCLUSIVE WARRANTIES PROVIDED BY LIFX, AND EXCEPT TO THE EXTENT PROHIBITED BY APPLICABLE LAW, ALL OTHER WARRANTIES, WHETHER EXPRESS OR IMPLIED WARRANTIES (INCLUDING WARRANTIES OF MERCHANTABILITY, FITNESS FOR A PARTICULAR PURPOSE AND NON INFRINGEMENT) ARE HEREBY EXCLUDED.

LIMITATION OF DAMAGES

EXCEPT TO THE EXTENT PROHIBITED BY APPLICABLE LAW, LIFX SHALL NOT BE LIABLE FOR ANY INCIDENTAL, INDIRECT, SPECIAL, OR CONSEQUENTIAL DAMAGES RESULTING FROM ANY USE OF THE PRODUCT OR BREACH OF EXPRESS OR IMPLIED WARRANTY OR CONDITION, OR UNDER ANY OTHER LEGAL THEORY. LIFX'S LIABILITY FOR DAMAGES RESULTING FROM ANY USE OF THE PRODUCT OR BREACH OF EXPRESS OR IMPLIED WARRANTY OR CONDITION, OR UNDER ANY OTHER LEGAL THEORY WILL BE LIMITED TO THE ORIGINAL COST PAID FOR OF THE DEFECTIVE PRODUCT.

Consumer Protection

Some states do not allow the exclusion or limitation of incidental or consequential damages, or allow limitations on how long an implied warranty lasts, so the above limitations or exclusions may not apply to you. This warranty gives you specific legal rights, and you may also have other rights that vary by state to state.

Governing Law and Arbitration

This Limited Warranty shall be governed by the laws of the State of California without giving effect to any conflict of laws principles that may provide the application of the law of another jurisdiction and without regard to the Convention on Contracts for the International Sale of Goods. Any claim or dispute in connection with this Limited Warranty shall be resolved in a cost effective manner through binding non appearance based arbitration. The arbitration shall be initiated through an established alternative dispute resolution provider mutually agreed upon by the parties. The alternative dispute resolution provider and the parties must comply with the following rules: a) the arbitration shall be conducted by telephone, online and/or be solely based on written submissions, the specific manner shall be chosen by the party initiating the arbitration; b) the arbitration shall not involve any personal appearance by the parties or witnesses unless otherwise mutually agreed by the parties; and c) any judgement on the award rendered by the arbitrator may be entered in any court of competent jurisdiction. If the foregoing arbitration clause does not apply for any reason, you agree to submit to the personal jurisdiction of the state courts located within San Francisco County, California and the federal courts in the Northern District of California for the purpose of litigating all such claims or disputes, which courts shall have exclusive jurisdiction of such claims or disputes. Notwithstanding the foregoing, LIFX may seek injunctive or other equitable relief to protect its intellectual property rights in any court of competent jurisdiction.